



WorkspaceCT Membership for LearnerSpace Members

EdAdvance and Cooperative Educational Services (CES) have partnered to purchase a unique property in Bethel, Connecticut. WorkspaceCT is a 32,000-square-foot building with a variety of innovative teaching and learning spaces, state-of-the-art technology, and equipment for hands-on learning. This collaborative initiative between two of Connecticut's Regional Education Services Centers (RES-C) is a first of its kind. LearnerSpace is a community of homeschoolers with an agreement with WorkspaceCT for building access. Fee details for this access are outlined below. This specific WorkspaceCT Membership agreement is offered exclusively to LearnerSpace members.

Building Access

Monday - Friday 11am-5pm

Members have access to the building facilities, common areas, Membership Rooms, and Personal Use Rooms. (see map)

Membership Rooms

These rooms (see map) are intended primarily for class or group activities and can be reserved on an hourly basis.

Semester Schedules

- **Semester 1**

July 1, 2022 - December 31, 2022

- **Semester 2**

January 1, 2023 - June 30, 2023

Fee Structure

- One-time **setup fee** to WorkspaceCT of \$450 per family
This includes background checks, ID cards, building orientation, etc.
- Per semester **membership fee** to WorkspaceCT of \$1000 per learner.
 - 10% discount for full-year payment - \$1,800

For 2022, payment is due by July 15th

Cubicle Rentals

Cubicles are available for semester rental for families wanting a dedicated desk space. The cubicle area is considered a quiet work area.

- **Cubicle \$550 per semester**

- Discount for full-year payment - \$1,000

Important Details

- All children must be accompanied by an adult, parent, or guardian who is an active member.
- Families are responsible for organizing their children's education.
- Guests are welcome with a member family for a \$5 per guest, per visit fee.
- We are glad to make the building available after hours, or for adult non-WorkspaceCT-related activities during the day, (i.e. work meetings, quiet place to work, adult online training, etc). Please contact us for additional terms.

For registration or questions, please contact Rich Reynolds, Director of WorkspaceCT richard.reynolds@workspacet.org For inquiries about the homeschool community, please contact info@learner-space.org or www.learner-space.org



Map of First Floor

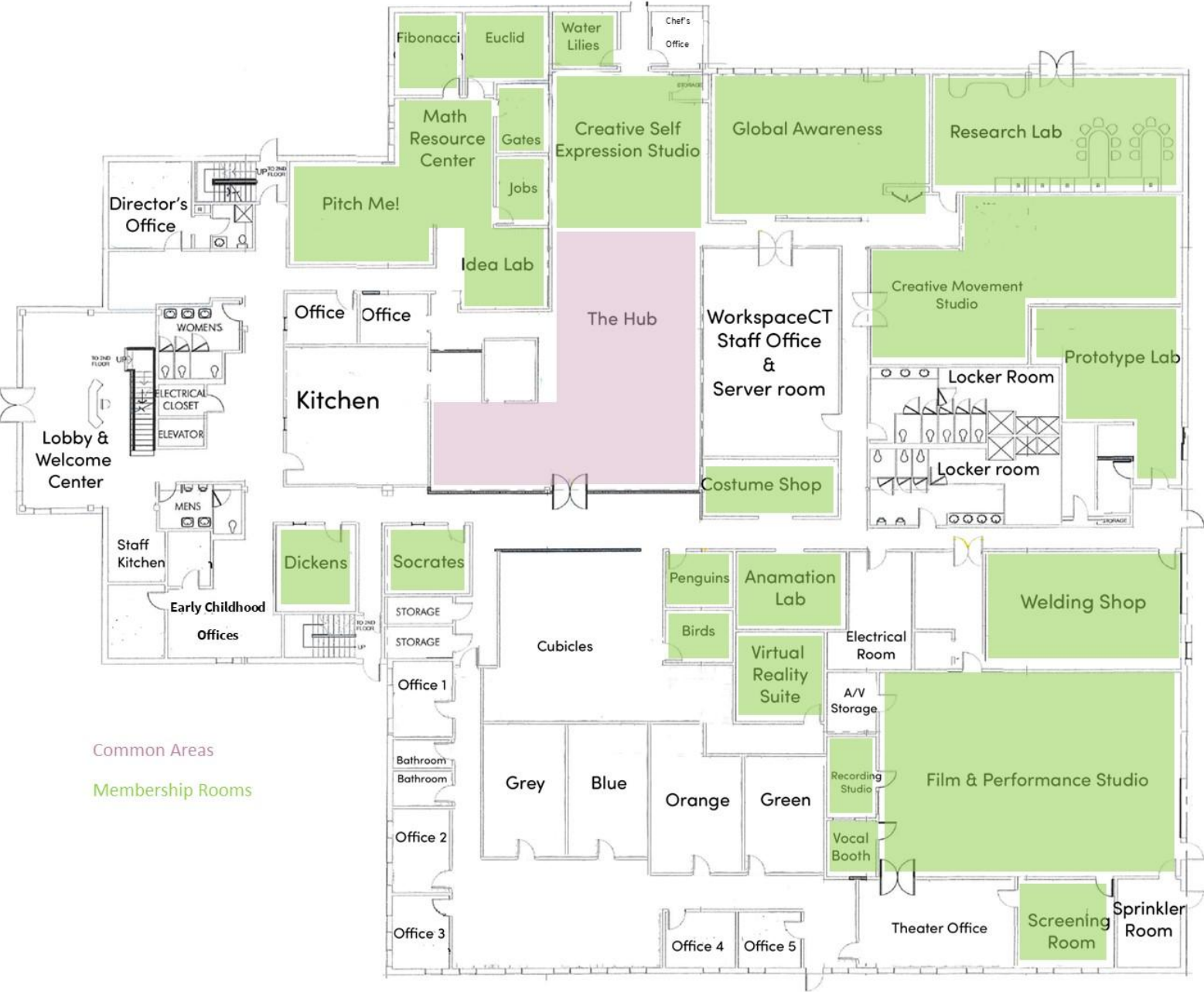

Common Areas
Membership Rooms

